

SK32AF~SK310AF

SURFACE MOUNT SCHOTTKY BARRIER RECTIFIER

VOLTAGE 20 to 100 Volt **CURRENT** 3 Ampere

DO-221AC/SMAF Unit:mm

FEATURES

- Low power loss, High efficiency
- High surge capacity
- High current capacity, low V_F
- Lead free in compliance with EU RoHS 2.0

MECHANICAL DATA

- Case Material: Molded Plastic.
- UL Flammability Classification Rating 94V-0

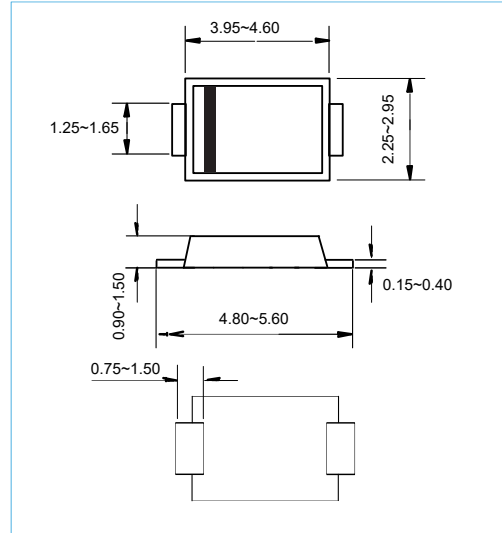
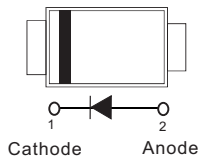

MAXIMUM RATINGS AND ELECTRICAL CHARACTERISTICS

Ratings at 25°C ambient temperature unless otherwise specified.

PARAMETER	SYMBOL	SK32AØ	SK33AØ	SK34AØ	SK35AØ	SK36AØ	SK38AØ	SK310AØ	UNITS
Maximum Recurrent Peak Reverse Voltage	V_{RRM}	20	30	40	50	60	80	100	V
Maximum RMS Voltage	V_{RMS}	14	21	28	35	42	56	70	V
Maximum DC Blocking Voltage	V_{DC}	20	30	40	50	60	80	100	V
Maximum Average Forward Current	$I_{F(AV)}$	3							A
Peak Forward Surge Current : 8.3ms single half sine-wave superimposed on rated load	I_{FSM}	80							A
Maximum Forward Voltage at 3 A	V_F	0.50		0.75		0.85		V	
Maximum DC Reverse Current at Rated DC Blocking Voltage $T_J=25^{\circ}C$ $T_J=100^{\circ}C$	I_R	0.5 20							mA
Thermal Resistance	$R_{\theta JA}$ $R_{\theta JL}$	80 10							$^{\circ}C / W$
Typical Junction Capacitance	C_J	250							pF
Operating Junction Temperature Range	T_J	-55 to +125							$^{\circ}C$
Storage Temperature Range	T_{STG}	-55 to +150							$^{\circ}C$

SK32AF~SK310AF

RATING AND CHARACTERISTIC CURVES

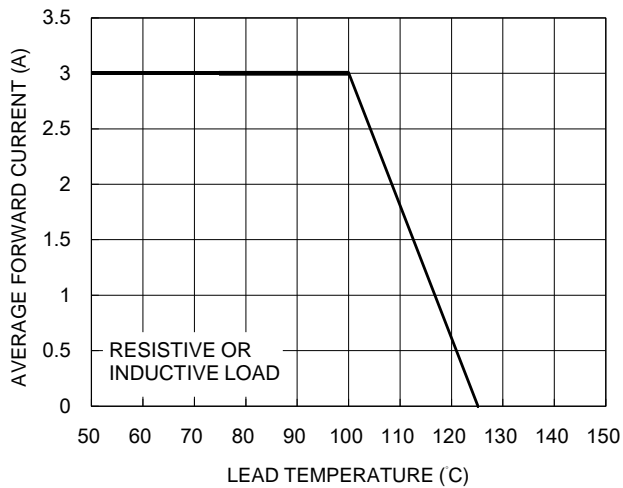

FIG.1 FORWARD CURRENT DERATING CURVE

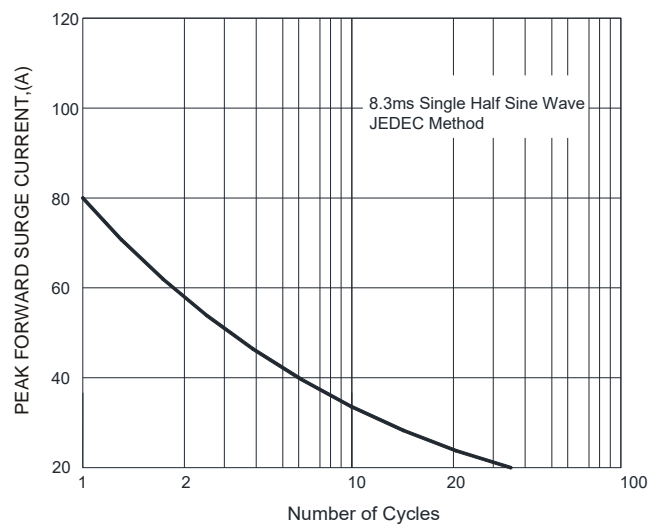

FIG.2 MAXIMUM NON-REPETITIVE PEAK FORWARD SURGE CURRENT

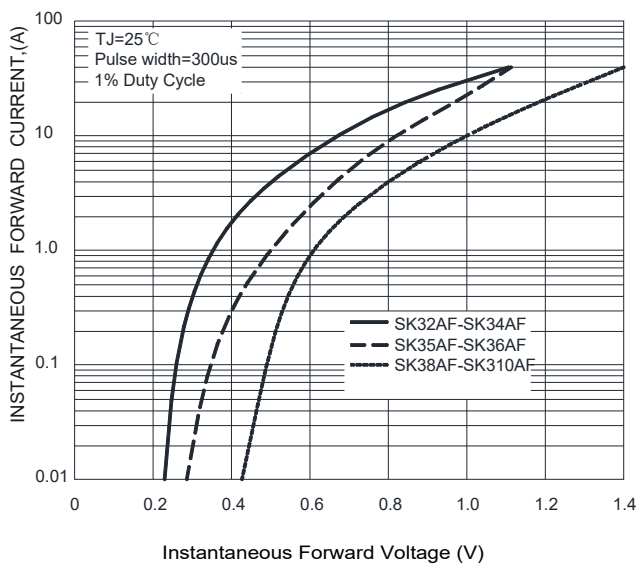

FIG.3 TYPICAL FORWARD CHARACTERISTICS

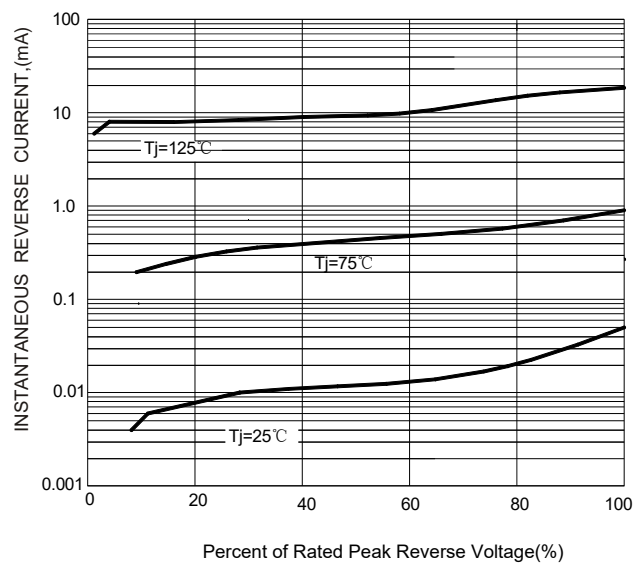

FIG.4 TYPICAL REVERSE CHARACTERISTICS

SK32AF~SK310AF

MOUNTING PAD LAYOUT

DO-221AC/SMAF

Unit:Inch(mm)

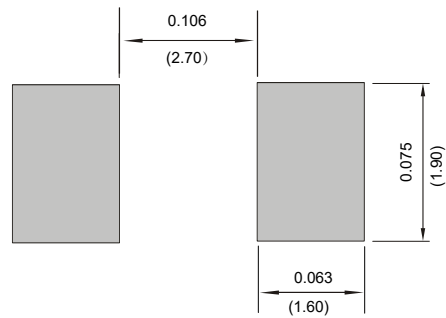

ORDER INFORMATION

- Packing information

Part Number	Case	Reel Size	QUANTITY
SK32AF~SK310AF	DO-221AC	13 Inch	10000